

**REGISTER SEARCH STATEMENT (Title Search) Transfer of
Land Act 1958**

VOLUME 09754 FOLIO 385

Security no : 124086823409H
Produced 27/11/2020 12:22 PM

ADVERTISED COPY

LAND DESCRIPTION

Land in Plan of Consolidation 165016Q.
PARENT TITLE Volume 09409 Folio 361
Created by instrument CP165016Q 26/06/1987

REGISTERED PROPRIETOR

Estate Fee Simple
Sole Proprietor
D&G BROTHERS MANAGEMENT GROUP PTY LTD of LEVEL 25 385 BOURKE STREET
MELBOURNE VIC 3000
AS896350S 15/01/2020

ENCUMBRANCES, CAVEATS AND NOTICES

MORTGAGE AT075663Q 16/03/2020
NATIONAL AUSTRALIA BANK LTD

Any encumbrances created by Section 98 Transfer of Land Act 1958 or Section 24 Subdivision Act 1988 and any other encumbrances shown or entered on the plan or imaged folio set out under DIAGRAM LOCATION below.

DIAGRAM LOCATION

SEE CP165016Q FOR FURTHER DETAILS AND BOUNDARIES

ACTIVITY IN THE LAST 125 DAYS

NIL

-----END OF REGISTER SEARCH STATEMENT-----

Additional information: (not part of the Register Search Statement)

Street Address: 409 CLAYTON ROAD CLAYTON VIC 3168

ADMINISTRATIVE NOTICES

NIL

eCT Control 16089P NATIONAL AUSTRALIA BANK LIMITED
Effective from 16/03/2020

DOCUMENT END



Imaged Document Cover Sheet

The document following this cover sheet is an imaged document supplied by LANDATA®, Victorian Land Registry Services.

Document Type	Plan
Document Identification	CP165016Q
Number of Pages (excluding this cover sheet)	1
Document Assembled	27/11/2020 12:37

Copyright and disclaimer notice:

© State of Victoria. This publication is copyright. No part may be reproduced by any process except in accordance with the provisions of the Copyright Act 1968 (Cth) and for the purposes of Section 32 of the Sale of Land Act 1962 or pursuant to a written agreement. The information is only valid at the time and in the form obtained from the LANDATA® System. None of the State of Victoria, LANDATA®, Victorian Land Registry Services Pty. Ltd. ABN 86 627 986 396 as trustee for the Victorian Land Registry Services Trust ABN 83 206 746 897 accept responsibility for any subsequent release, publication or reproduction of the information.

The document is invalid if this cover sheet is removed or altered.

OFFICE USE ONLY

CP 165016 Q

NOTATIONS

SEALED PURSUANT TO SECTION 569 AB OF THE LOCAL GOVERNMENT ACT 1958.

CERTIFICATION BY SURVEYOR

I CERTIFY THAT THIS PLAN HAS BEEN MADE BY ME OR UNDER MY IMMEDIATE SUPERVISION AND ACCORDS WITH TITLE.

John W. Brennan
Licensed Surveyor
Date 22.2.87

CHART No 65

PLAN APPROVED

[Signature]

(ASSISTANT) REGISTRAR OF TITLES 26.6.87
THE LAND TO BE CONSOLIDATED IS SHOWN ENCLOSED BY CONTINUOUS THICK LINES
TITLE REF: VOL. 9409 FOL. 361
LAST PLAN REF: L.P. 8189

PLAN OF CONSOLIDATION

COUNTY BOURKE
PARISH MORDIALLOC
SECTION 2
CROWN ALLOTMENT 10 (PART)

SCALE
8 4 0 8 16
LENGTHS ARE IN METRES
ORIGINAL SCALE SHEET SIZE A3

CP 165016 Q

VICTORIA

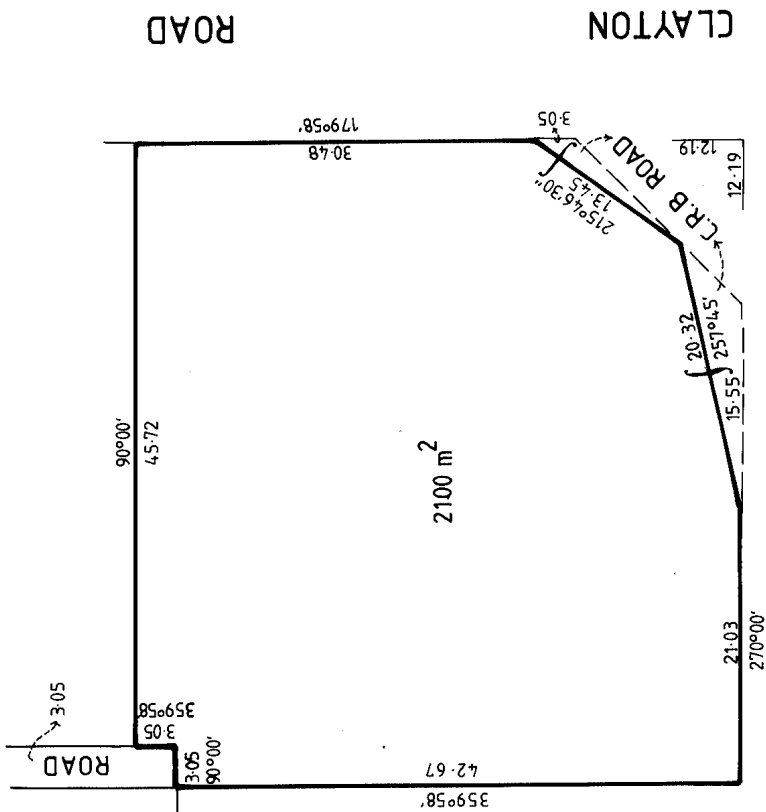

CLAYTON ROAD
CENTRE ROAD
ROAD

SEAL AND ENDORSEMENT OF MUNICIPALITY
MUNICIPALITY CITY OF OAK LEIGH COUNCIL REF.

[Signatures and stamps]
38 M.S.E.C.L.
Municipal Engineer
City of Oak Leigh

SURVEYORS REF. 34591
GARLICK & STEWART PTY. LTD.
Consulting Engineers and Surveyors
341 QUEEN STREET, MELBOURNE, 3000.
TELEPHONE: (03) 329 6433

0 10 20 30 40 50 60 70 80 90 100 110 120 130 140 150mm

C.B. 2/15